

### Bringing the street back to people

The road access was kept but reducing the speed limit and opportunity for permeable parking solutions.

Outdoor terraces for the existing cafes and bars were considered and larger sitting areas created as part of the strategy to increase the social interaction

### Practical space

Space was kept to its most practical uses thought for the current users

Pedestrians were given priority in order to connect the square with the surrounding town centre areas forming a transport corridor

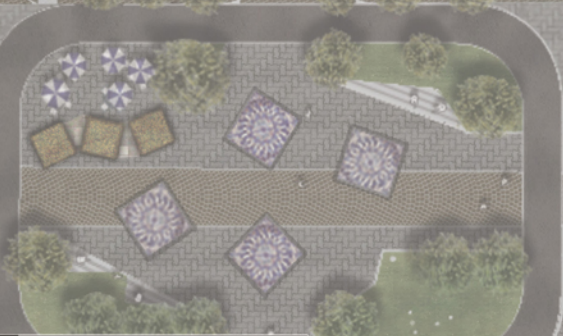

### Plaça de la Constitució, Castelló Spain//

The slimArpa approach was to turn this once broken public square into an interconnected recreational urban space. The link with the surrounded areas was given priority while neighbours can still adopt this space as representative for them.

