



## Gjakova, Kosovo. 2015

### Relinking two districts in the heart of the city



Space occupation diagnosis

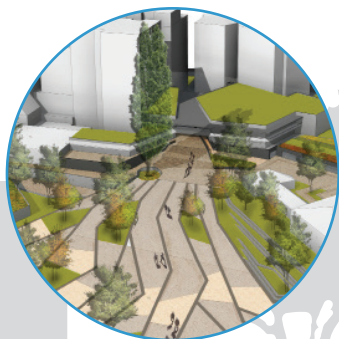

Public spaces design

Lack of accessibility and attraction were the main issues the municipality of Gjakova, Kosovo, desired to solve in the centre of the city (90'000 inhabitants). Thus, a project of ideas on urban renewal planning designed to enhance the quality of life in the core of the city has been placed by simArpa within an international competition (European) framework.

The river Krena (splitting the city centre in two parts), which throughout the years has been acting as barrier for the integrated development of the city around its banks, was for us the centre of our concepts in order to physically and emotionally rely the two sides of the city centre.

After an accurate analysis integrating landscape, mobility and identity in the local and regional context and paying specially attention to the citizen's perspective integration and the economic situation of the Kosovar city, simArpa designed efficient and amortisable proposals to guarantee the own cultural and commercial dynamics of the city within a coherent urban fabric.

We designed an adaptation of an important part of the existing infrastructures, modifying their permeability and design by accentuating and boosting the identity of the neighbourhood's special buildings, activities and natural characteristics. With our proposals, we aimed to welcome the citizens to experience a renewed and integrated city centre, reconnecting, thanks to the integration of the river, the same that until now, the urban planning turned its back to.

Project Team: Breogan Sanchez (simArpa) | Alberto Gramegna | Zuzana Prochazkova